

# LA CANTINA: Floorplan & Specifications

## PIMA COUNTY FAIRGROUNDS

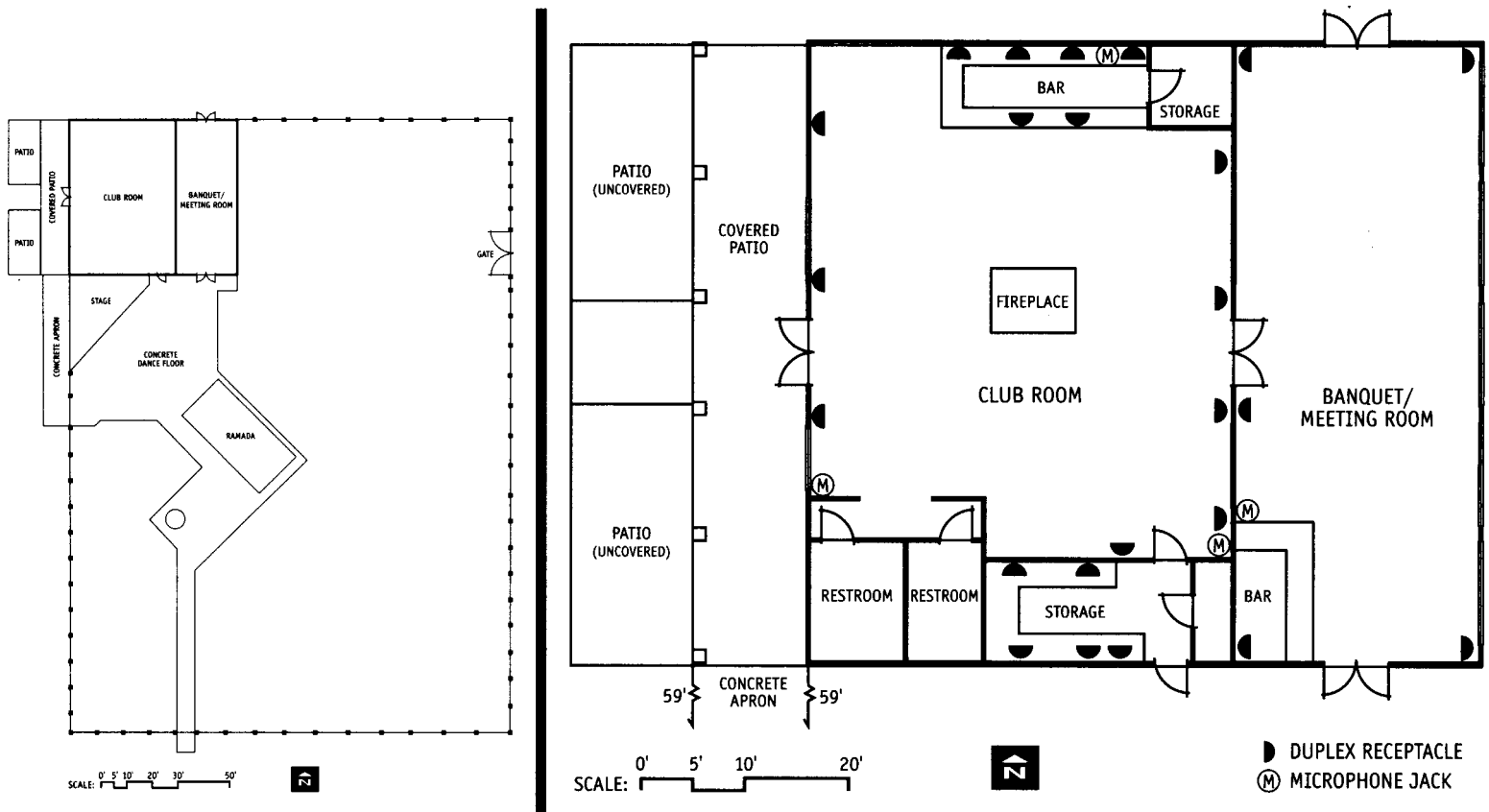

Combining southwestern style and Old World charm, La Cantina is the ideal place at the Pima County Fairgrounds for weddings, parties, company picnics, family reunions, banquets and meetings for 100 to 300 people. La Cantina offers gracious, yet economical, indoor and outdoor facilities for your function with a full-service bar, fireplace, banquet/meeting room, outdoor stage, and a garden setting.

### Square Footage:

Club Room - 2,050  
 Banquet/Meeting Room - 1,440  
 Overall Exterior Area - 31,100  
 Dance Floor - 1,820  
 Front Patio - 1,650  
 Ramada - 860

### Measurement:

Club Room - 50' x 41'  
 Banquet/Meeting Room - 60' x 24'  
 Ceiling Height: Club Room - 9'  
 Banquet/Meeting Room - 9' to 7.5' (west to east walls)  
 Overall Exterior Area - 238' x 147'  
 Dance Floor - Approx. 50' x 38' x 20' x 20'  
 Front Patio - Two sections, 33' x 25' each  
 Ramada - 43' x 20'

### Utilities:

Electrical, heating and air conditioning

### Electrical:

Single phase 120-200  
 Duplex wall outlets:  
 120 volts - 15 amps  
 Club Room - 16  
 Banquet/Meeting Room - 5  
 Lighting - flush-mount ceiling incandescent

### Seating:

Banquet/Meeting Room:  
 Banquet-style - 130  
 Buffet-style - 165  
 Theatre-style - 200  
 Club Room:  
 Bar - 18  
 Banquet-style - 85  
 Outside Stage/Ramada:  
 Theatre-style - 300

### Public Restrooms:

Ladies: regular - handicap  
 Men: regular - handicap

### Other Amenities:

TV/Audio/Video System  
 Indoor Public Address System  
 Full-service bar and fireplace in Club Room  
 Fully carpeted  
 Outdoor firepit

**SOUTHWESTERN  
 Fair COMMISSION, INC.**

(A Non-Profit Corporation)  
 Presents the PIMA COUNTY FAIR

11300 S. Houghton Road  
 Tucson, Arizona 85747 - 9755  
 520-762-9100 • Fax 520-762-5005